



LADY FREYA

22,76 m (74'8") | 4 Cabins | 8 Guests



Exterior

LADY FREYA

22,76 m (74'8") | 4 Cabins | 8 Guests



Exterior

LADY FREYA

22,76 m (74'8") | 4 Cabins | 8 Guests



Sailing

LADY FREYA

22,76 m (74'8") | 4 Cabins | 8 Guests



Sailing

LADY FREYA

22,76 m (74'8") | 4 Cabins | 8 Guests



Bird's Eye View

LADY FREYA

22,76 m (74'8") | 4 Cabins | 8 Guests



Forward Seating Area

LADY FREYA

22,76 m (74'8") | 4 Cabins | 8 Guests



Forward Sunbathing Area

LADY FREYA

22,76 m (74'8") | 4 Cabins | 8 Guests



Aft Dining & Lounging

LADY FREYA

22,76 m (74'8") | 4 Cabins | 8 Guests



Aft Dining & Lounging

LADY FREYA

22,76 m (74'8") | 4 Cabins | 8 Guests



Saloon

LADY FREYA

22,76 m (74'8") | 4 Cabins | 8 Guests



Saloon

LADY FREYA

22,76 m (74'8") | 4 Cabins | 8 Guests



Galley

LADY FREYA

22,76 m (74'8") | 4 Cabins | 8 Guests



Aft Master Cabin

LADY FREYA

22,76 m (74'8") | 4 Cabins | 8 Guests



Aft Master Cabin

LADY FREYA

22,76 m (74'8") | 4 Cabins | 8 Guests



Forward Master Cabin

LADY FREYA

22,76 m (74'8") | 4 Cabins | 8 Guests



Forward Master Cabin

LADY FREYA

22,76 m (74'8") | 4 Cabins | 8 Guests



Port Side Double Cabin

LADY FREYA

22,76 m (74'8") | 4 Cabins | 8 Guests



Starboard Side Double Cabin

LADY FREYA

22,76 m (74'8") | 4 Cabins | 8 Guests



Aft Master Cabin Bathroom

LADY FREYA

22,76 m (74'8") | 4 Cabins | 8 Guests



Forward Master Cabin Bathroom

LADY FREYA

22,76 m (74'8") | 4 Cabins | 8 Guests



Double Cabin Bathrooms

LADY FREYA

22,76 m (74'8") | 4 Cabins | 8 Guests



Double Cabin Bathrooms

LADY FREYA

22,76 m (74'8") | 4 Cabins | 8 Guests



Sailing

LADY FREYA

22,76 m (74'8") | 4 Cabins | 8 Guests

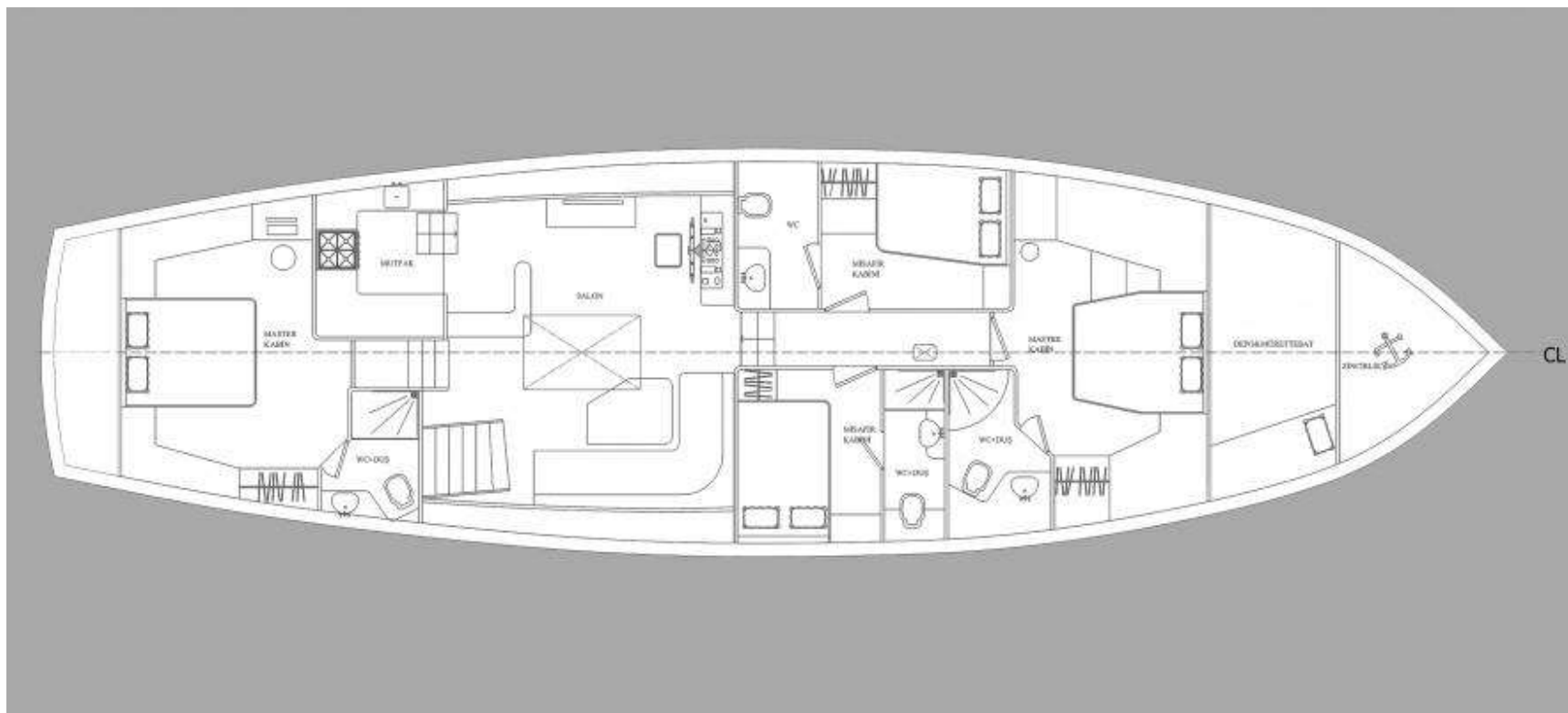

General Arrangement

LADY FREYA

22,76 m (74'8") | 4 Cabins | 8 Guests

SPECIFICATIONS

| | |
|-----------------------|---|
| LOA (incl. pulpit) | 25,50 m / 83'8" |
| Length Hull | 22,76 m / 74'8" |
| Beam | 6,05 m / 19'10" |
| Draught | 2,74 m / 9' |
| Flag | Polish |
| Cabins | 4 |
| Guests | 8 |
| Built / Refit | 2008 / 2023 |
| Builder | Orion Shipyards |
| Displacement | 48 tons |
| Engine(s) | 1x Volvo Penta 425 hp |
| Generator(s) | 1 x Onan 17,5 kW 1 x Albo Marine 14 kW |
| Fuel Consumption | 40 liters/hr @ cruising speed |
| Cruising / Max. Speed | 9 / 11 knots |
| Range | 600 nm |
| Fuel Capacity | 2800 l |
| Fresh Water Capacity | 4000 l |
| A/C | 24 Hours |
| Crew | Captain + 2 |

ACCOMMODATION

- Saloon with A/C, open galley, dining area for 8 guests
- 1 aft master cabin with queen size bed, bathroom, A/C
- 1 forward master cabin with queen size bed, bathroom, A/C
- 2 port and starboard double cabins, bathroom, A/C
- 1 forward crew quarter for 3 crew members

AMENITIES

- 1x 4,20m Tender 70 hp (8 guests)
- 1x Single Canoe
- 1x Double Canoe
- 2x Paddle Boards
- 1x Adult Water Ski
- 1x Child Water Ski
- 1x Mono Ski
- 1x Wakeboard
- 2x Ringos
- Snorkeling Equipment
- Fishing Equipment (2x rods, 2x longlines, 6x basic lines)
- Satellite TV in Saloon and Aft Deck
- DVD/CD Player in Saloon
- Board Games
- Bluetooth Speakers
- Wi-Fi